

DOSI-FUSER®

SUCCESSFUL USE of the DOSI-FUSER® relies upon effective patient teaching. Please help your patient to have a safe, comfortable, trouble free experience.



Checking, connection and disconnection

Key nursing points to remember



CHECKING

- Ensure full patency of the vascular access device per facility protocol flushing prior to connecting the DOSI-FUSER.
- Check the patient label per facility protocol.

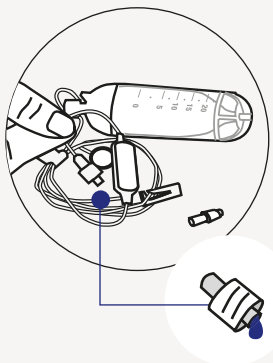

CONNECTION

- Remove the infusion line cap, ensure the line is primed and free from air.
- Connect to the patient.

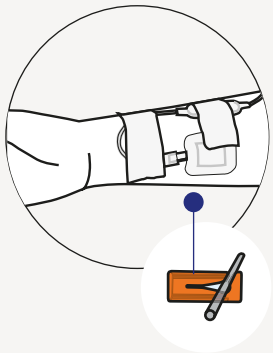

- Unclamp the infusion line.
- Affix Capillary Device to the patient's skin.

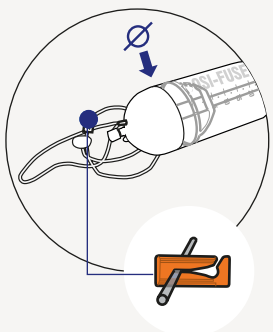

DISCONNECTION

- Clamp the infusion line and disconnect it from the patient.
- Dispose of the infuser in accordance with institution protocol.

Nursing staff: DOSI-FUSER® is a single-use elastomeric continuous infusion pump. It provides a comfortable home infusion experience.

Patient education is important!

Key points your patient must know



WHERE IS IT WORN?

DOSI-FUSER should be worn between axilla and the waist. When in bed, anywhere at patient level.

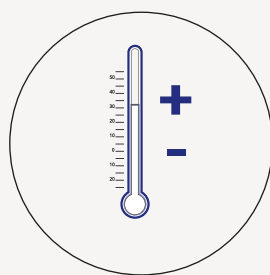

WHAT KEEPS THE INFUSION RATE CONSTANT?

The restrictor capillary device: this must be attached directly to the skin keeping the pump as close as possible to ambient room temperature.

Avoid exposing the pump to extremes of temperature, no heating blankets, out of sunlight/extreme cold environments.

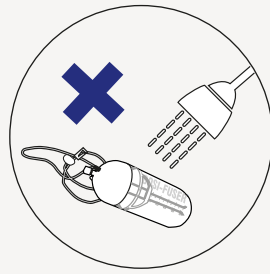

BATHING/SHOWERING?

Protect the pump from direct water streams. Avoid getting the filter wet at all times.

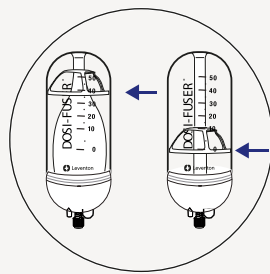

HOW DO I KNOW IF IT IS INFUSING OR IS FINISHED?

The white plastic level indicator inside the pump gradually moves down the blue numbered scale as the balloon empties. Infusion is finished when the white level indicator is at zero.

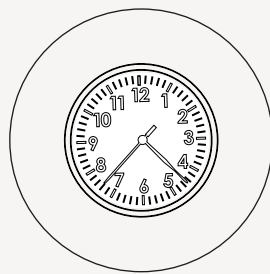

WHAT IF IT FINISHES EARLIER OR LATER THAN EXPECTED?

This type of pump may finish **earlier or later** the targeted time.

Explain to the patient the time margin in which the infusion may end, indicating the **number of hours of margin**.

